

Bolton Town Hall Basement Plan 1873 (now ground floor)

- 1** Detectives (Police Department)
- 2** Chief Constable
- 3** Receiving Office
- 4** Police Clerks
- 5** Cells
- 6** Police Waiting and Dining Room
- 7** Police Parade
- 8** Borough Analyst
- 9** Porter
- 10** Medical Officer of Health
- 11** Inspectors of Nuisance
- 12** Pay Office
- 13** Rate Office
- 14** Waterworks Stores
- 15** Waterworks Offices
- 16** Hydraulic Engines for Organ
- 17** Kitchen
- 18** Warming Apparatus
- 19** Storeroom
- 20** Lavatories and Water Closets
- 21** Entrances
- S** Staircases

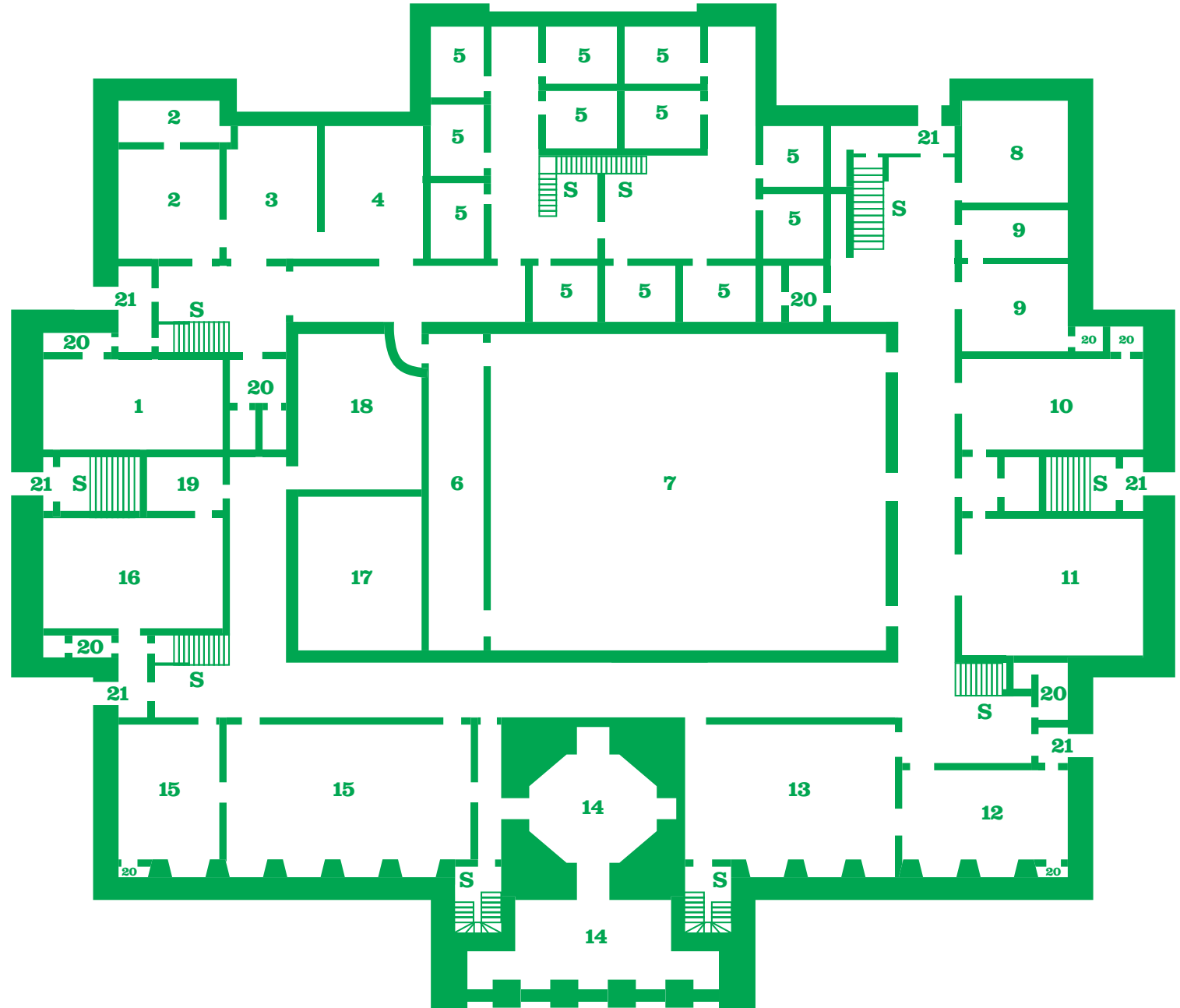

An above-ground basement...

The present Ground Floor was designated as the Basement because the 1873 Ground Floor was where the main entrance was - at the top of the steps!